

[Under Development]

EXTERNAL DIMENSIONS

Brushed Motor

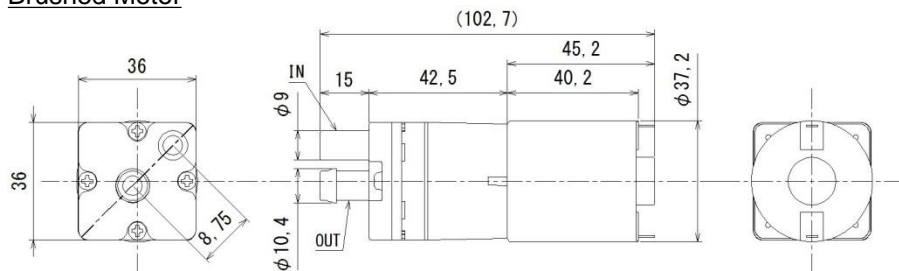

SPECIFICATIONS

Model Number	S36L_0001_D
Motor	DC Brushed Motor
Type	Diaphragm Pump
Rated Voltage	DC 24V
Flow Rate at 0kPa	> 3L/min
Current Consumption at 0kPa	< 800mA
Maximum Pressure	> 300kPa
Ambient Temperature Range	5 – 50°C
Fluid Temperature Range	5 – 98°C
Durability	3000H
Noise level	-
Wetted Materials	SPS / EPDM
Port Connection	Inlet: Straight Barb
	Outlet: Hose barb (Tube Retaining Design)
Weight	270g
Food Sanitation Act	-

Note: Values are tentative and subject to change.

CHARACTERISTIC CURVE

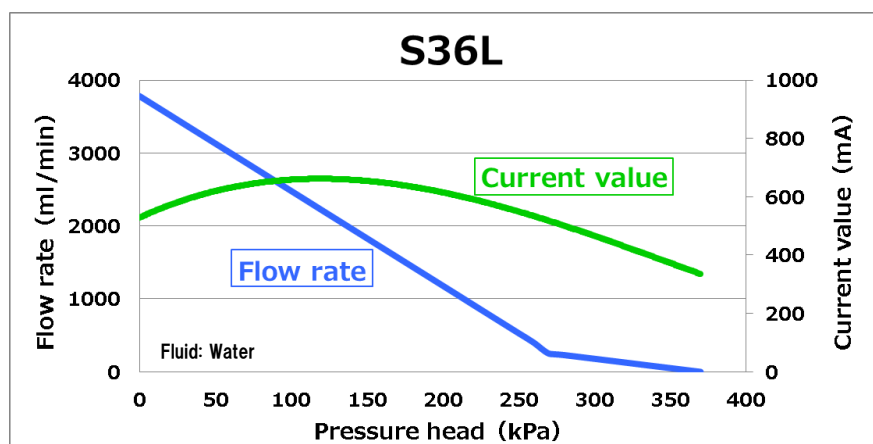

Note: Details such as specifications, etc., may be changed without notice.

